

**Leonelli®**



## MAGNETIC KILL SWITCH

REF. 171- 181

*Champions technology  
and safety at hand*

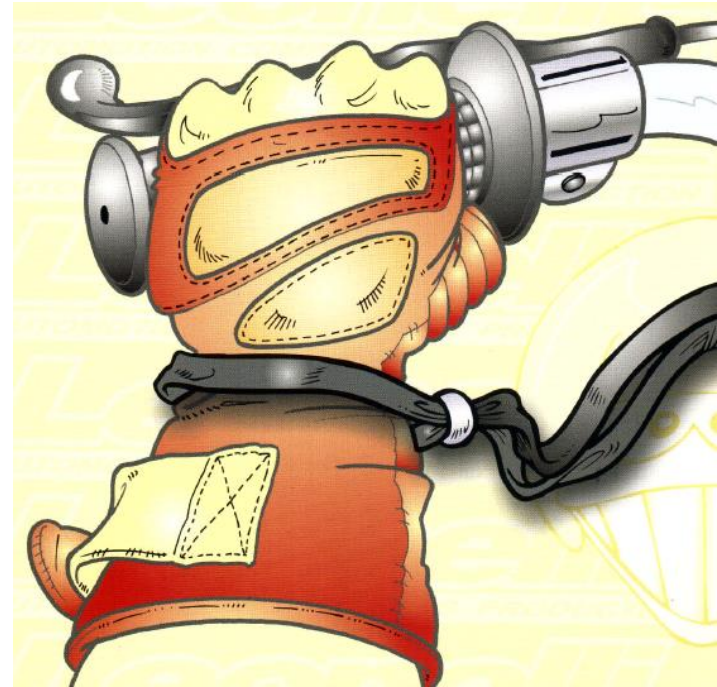



### KILL SWITCH

#### Purpose

Our new REF. 171 - 181 integrates a magnetic central **kill switch lanyard** and up to 2 extra push-buttons or 2 led or smart led tell-tales.

REF. 171 - 181 is an essential command device for vehicles to ensure the safety of the rider and pedestrians by avoiding to have an accelerated and uncontrolled vehicle.

Its use is recommended by most European Federations as well as many of the international championships.

His small dimensions and the several customization options allows you to adapt it to any need or vehicle.





### CENTRAL START/STOP VERSION

- Two push-buttons or tell-tales
- Central kill switch lanyard
- Kill switch can be mounted left or right on the handlebar.

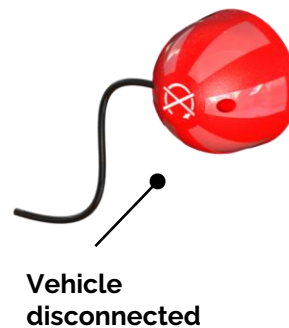
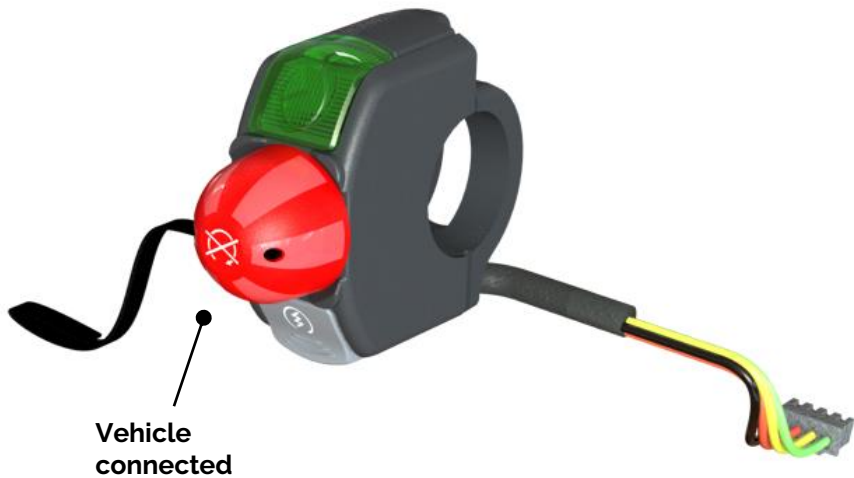



### CENTRAL START/STOP VERSION

- Two push-buttons or tell-tales
- Central kill switch lanyard
- Part can be mounted on the left or on the right on the handlebar.

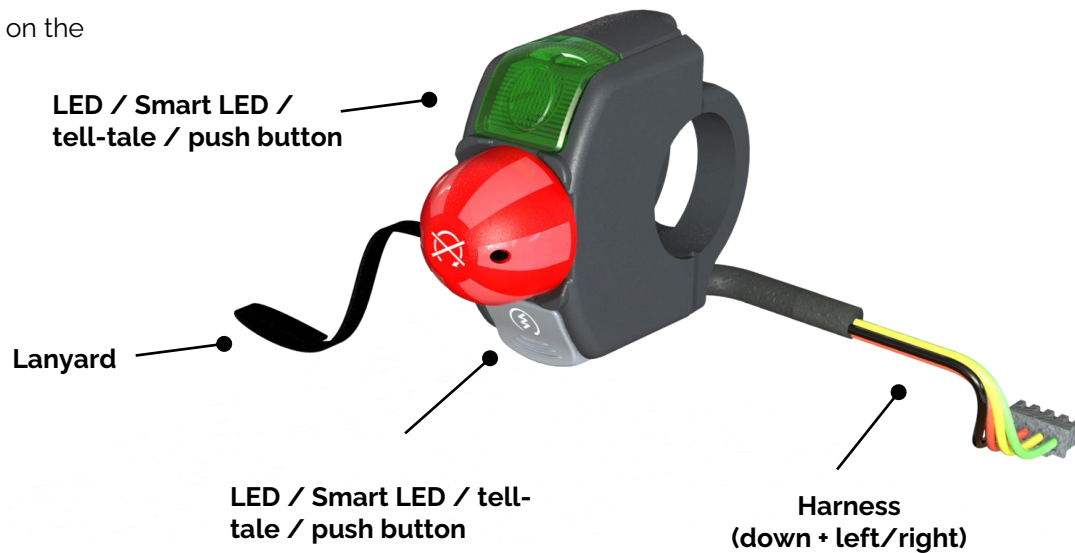
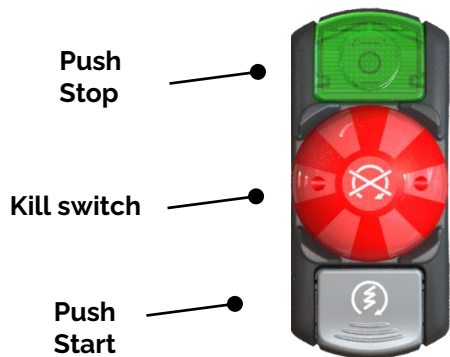



### ELECTRICAL CIRCUIT

#### NORMALLY OPEN 171

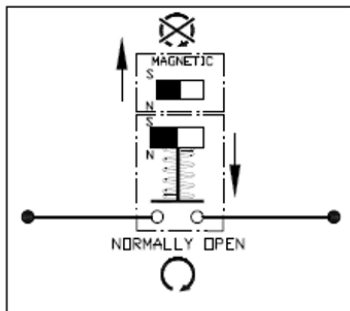

#### NORMALLY CLOSED 181

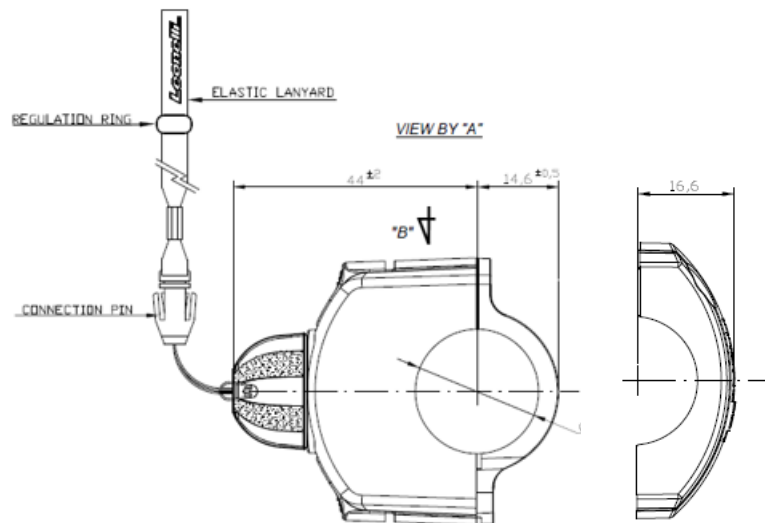
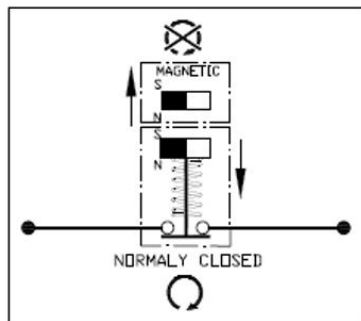

Clamp model A

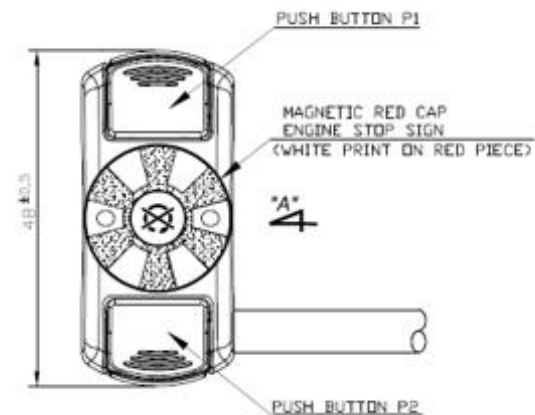

Clamp model B

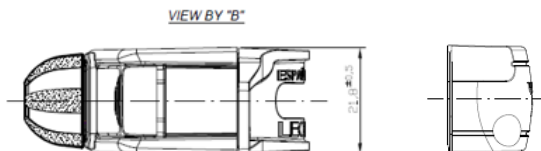



### TWO CLAMP VERSIONS

- Plastic Clamp suitable on the main handlebar dimensions
- Two fixation clamps options.  
Customize the device according the design your vehicle.



**Model A**



**Model B**



**Fixation  
Screws**



**Suitable for snow vehicles**

**Different colours availability**

**Check quantities for logo customization**

**Antitheft**



**User friendly**

**Waterproof**

**Essential tool to improve security**



#Smart

#Small

#Safe



European Quality

**THANK YOU**